



Jaw Crushers | The Edge In Crushing Power



JAW CRUSHERS

PORTABLE AND STATIONARY



OUTPERFORM THE COMPETITION

TEREX CEDARAPIDS' JAW CRUSHERS DELIVER GREATER VERSATILITY AND PRODUCTIVITY

As the demands of business get tougher, and the landscape more competitive, productivity becomes more and more important. And, the Cedarapids line of jaw crushers has a proven track record for unmatched performance and productivity. Inside and out, the advanced engineering of our jaws sets industry standards with features like the pitman drop-forged 4340 chrome-moly-nickel steel shaft and spherical self-aligning roller bearings. Each machine offers you an array of competitive advantages—from improved product quality to higher throughput capacities to the lowest operational costs.

THE DIFFERENCE IS IN THE DETAILS

BUILT FOR ENDURANCE

- Thick steel plate crusher bases eliminate the possibility of flaws often found in cast steel bases
- Submerged-arc welding creates a more solid joint than standard weldments
- Thermal stress relief and shot-blasting produces a solid one-piece unit

MORE EFFICIENT OPERATION

- Spherical, self-aligning roller bearings provide the smoothest low-friction operation possible
- Roller bearings require less power, less maintenance and last longer than plain bearings
- Roller bearings absorb side thrust and heavy radial loads without damage to themselves or the shaft, assuring pitman guidance without thrust shoes or other wear parts

LASTING STRENGTH

- Cedarapids pitman shafts made of drop forged 4340 chrome-moly-nickle steel withstand extreme temperatures
- Shaft forgings are heat treated to add tensile strength while finish is machined to resist fatigue
- Largest possible diameters are created through a step-cut machining and grinding method for maximum strength

OPERATING TIME, NOT DOWNTIME

- Side bearings are mounted in removable housings for easier maintenance possible in a clean environment to protect bearings from contamination
- Housing location insures rigid support to the bearings and pitman assembly, while eliminating cantilevered load stresses to the base frame

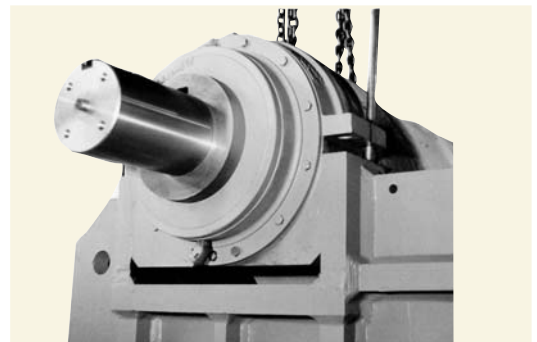
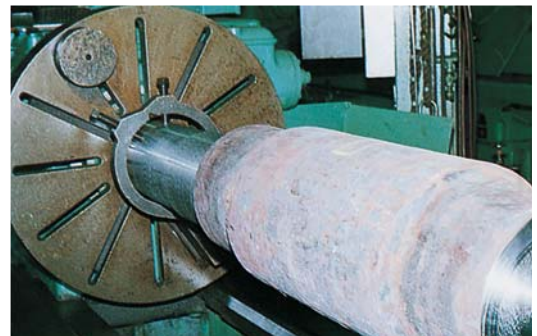
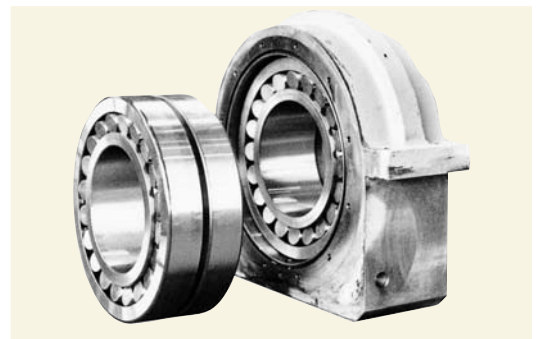

PRODUCE HIGHER YIELDS/GREATER PROFITS

HEAVY DUTY ADVANTAGES

Capacity, quality, yield and efficiency—the Cedarapids line of jaw crushers has the advanced technology to outperform the competition in every area. That means lower cost per ton, less downtime and greater profits. Our highly versatile jaw crushers offer reliable operation and adaptability for all types of feed materials.

INNER STRENGTHS

Arc-welded base frame is thermally treated to resist fatigue

Ribbed construction withstands hard and abrasive material

Oversized self-aligning roller bearings are readily available

Large flywheel maintains inertia to crush the hardest of materials

Easily accepts hard rock, gravel and recycle materials

Large diameter, heavy flywheels provide the necessary inertia for crushing while minimizing vibration

Large diameter, drop-forged, 4340 chrome-nickel steel pitman shaft insures maximum strength through years of tough crushing

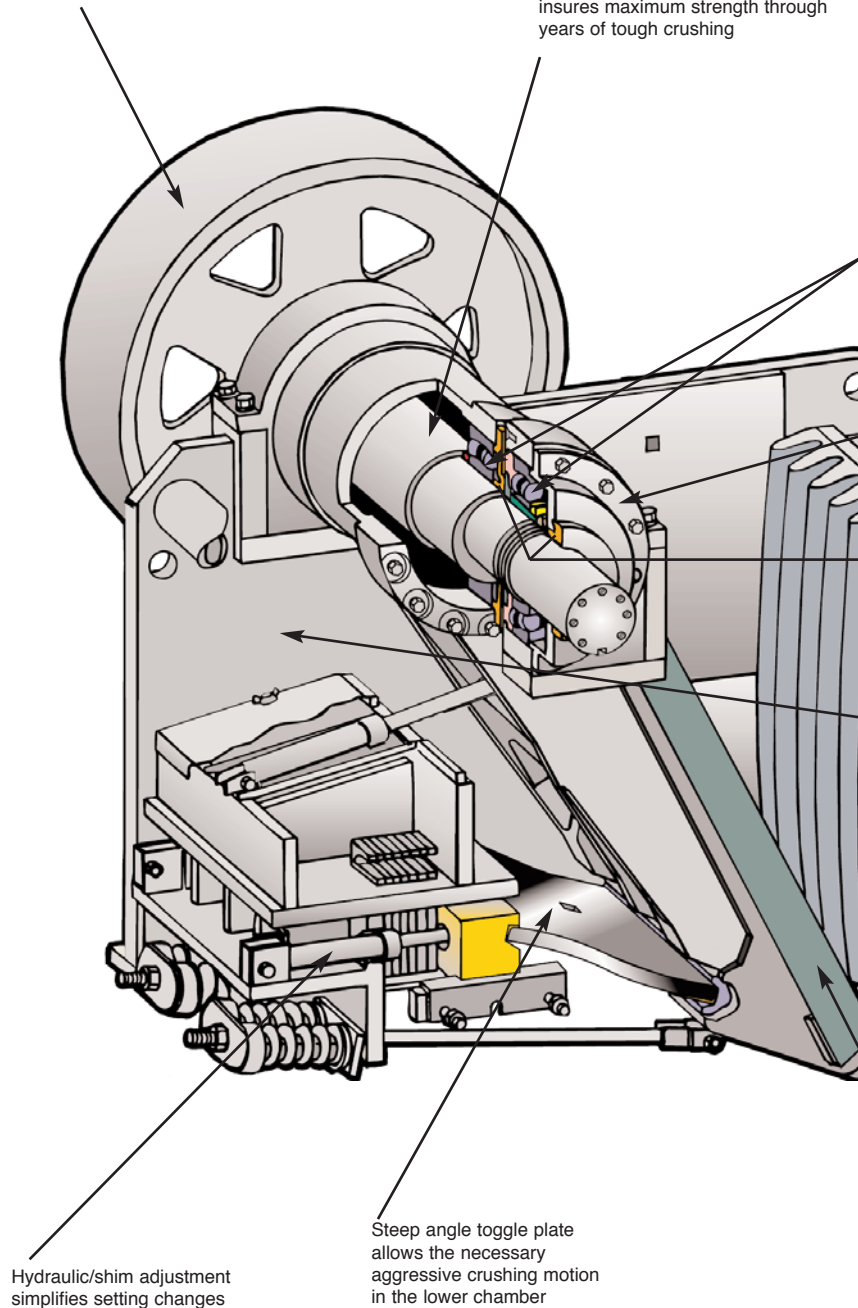

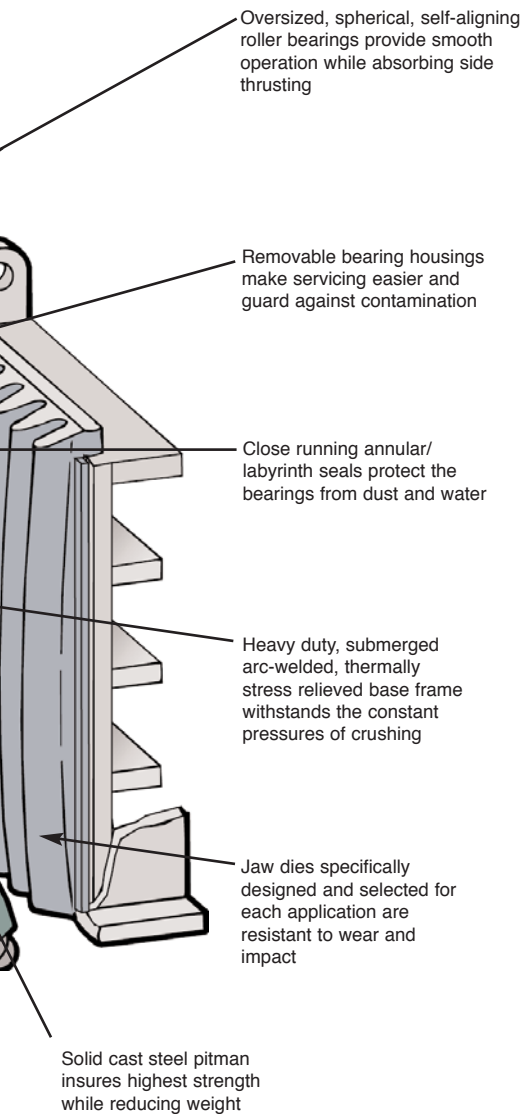

JAW CRUSHING POWER BUILT FOR EFFICIENCY

Whether your application requires a stationary plant or mobile unit, Terex Cedarapids has the system that's right for you. Our jaws are designed to integrate into whatever configuration you need to accommodate your precise crushing requirements. We're committed to helping you design a system built for maximum efficiency and productivity.





TEREX WORLD JAW CRUSHERS

HEAVY DUTY DESIGN DELIVERS HEAVY DUTY PRODUCTION

It all comes down to delivering the most tons of material, the most cost effectively. Built to deliver a low cost per ton, the Cedarapids Single Toggle World Jaw Crusher is designed for exceptionally heavy and continuous applications. Utilizing the latest technology, this crusher delivers high production, infinite setting adjustment, large feed opening, bolted mainframe and cast swing jaw holder.

Optional positioning of the crusher feet is designed to suit installation requirements for track, mobile and fixed plant mounting. This crusher is engineered to handle hard rock, ores and demolition concrete for the quarrying, mining and recycling industries.

WORLD JAW CRUSHER FEATURES PROVIDE MORE CRUSHING BENEFITS

- Designed for heavy-duty applications, the large diameter forged steel main shaft has no threads or tapered bearing journals, giving you higher strength and greater fatigue resistance
- Corrugated manganese jaws are reversible top to bottom for extended jaw life
- Unique rocking end design of toggle means no lubrication is required for toggle or seats



ROCK

SOLID DESIGN

ENGINEERED TO OUTPERFORM THE COMPETITION

MAIN FRAME – fully bolted and dowelled four-piece heavy-duty construction. Front and rear frames are cast high strength steel with the side plates produced from high strength structural plates.

FLEXIBLE INSTALLATION – mounting feet options allow for fitting in various positions for track, mobile or fixed plant installation.

JAW RETENTION – fixed and moving jaws are retained with a wedge locking system. The main frame and swing jaw holder are protected from wear due to the unique design of the jaw faces that protect the inlet and outlet points of the crushing chamber.

Wedges actuate from the side of the crusher for easy installation and maintenance. The rear frame and swing jaw holder are fitted with replaceable jaw face backing plates to protect the machined jaw face locations.

HYDRAULIC ADJUSTED WEDGE – allows for infinitely variable closed side setting adjustment. No shims required hydraulic power pack mounted to crusher without external hydraulic cylinders. Option to fit remote hydraulic actuated CSS control system.

Cross Section Through Toggle Arrangement

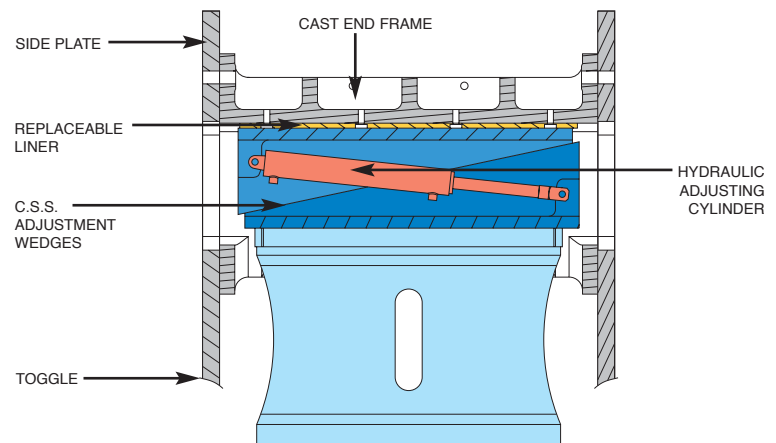

Jaw Crusher

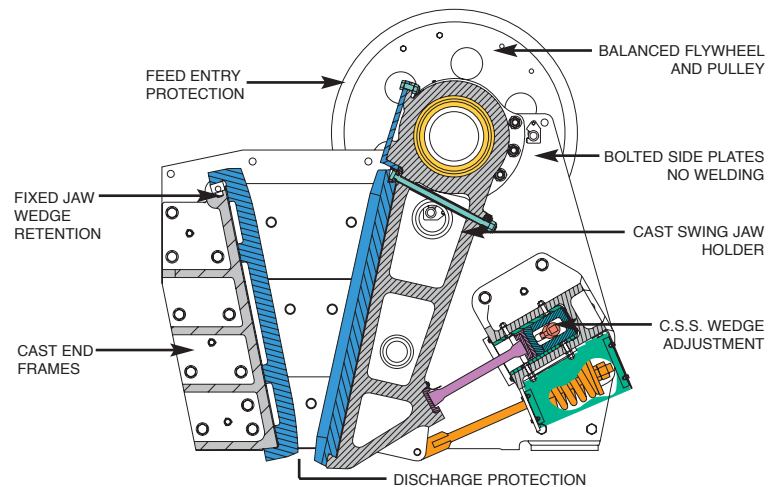

In today's competitive environment, it's good to have high quality equipment. It's even better to know that your equipment is backed by an outstanding support network. That's what we mean by "Better Together" at Cedarapids. The partnership between you and your local distributor assures you of on-the-spot parts and service, technical expertise and local application knowledge. With that kind of support, both you and your equipment will perform at peak levels. Cedarapids and you. "Better Together."

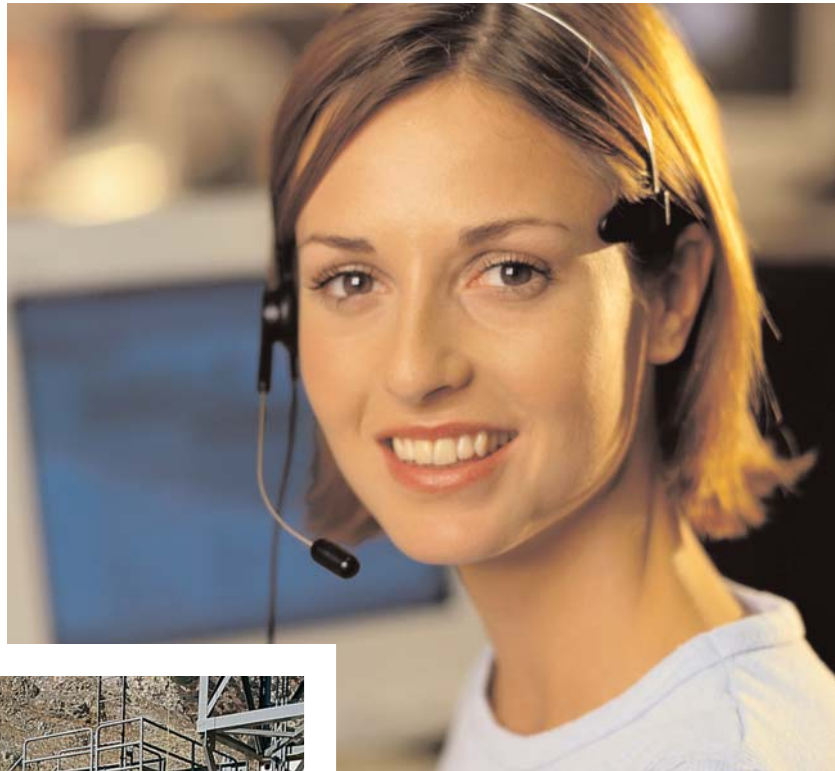

Bulletin 23880 (1/06)



TEREX | CEDARAPIDS

YOUR COMPETITIVE EDGE

909 17th Street NE • Cedar Rapids, IA 52402 USA
tel 319-363-3511 • fax 319-399-4871 • www.cedarapids.com



Terex® Minerals Processing Systems
Cedarapids JS

JS SERIES JAW CRUSHERS



WORKS FOR YOU.™

DESIGNED FOR PRODUCTIVITY

Rugged, Dependable, More Productive

Terex® Cedarapids jaw crushers are known for durable construction, high productivity and as a greater value for investment. And now, the new JS Series jaw crushers are built even more rugged and easy to use. We have taken our jaw crushers to a new level of reliability and convenience.

The new quick-change jaw die and quick-adjust hydraulic shim systems enable more uptime. Combine these features with our well-known durability and you have a crusher that keeps you up and running.

Reliability, quality, capacity, and ease of use — the new Terex® Cedarapids JS Series jaw crushers are designed to help you be more profitable.

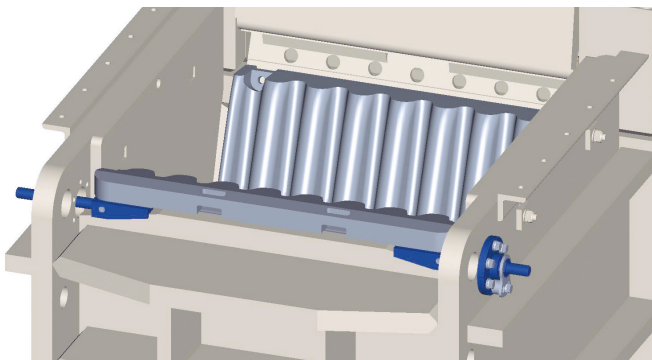

Quick-Change Jaw Die System

Jaw die wedges are highly accessible from the sides of the crusher and easily removed, allowing the jaw dies to be quickly changed.

Extra-large diameter, heavy split-hub flywheels for smooth operation even in tough conditions

Removable bearing housings make servicing easier and guard against contamination

Large spherical self-aligning roller bearings provide smooth operation while absorbing side thrusting

Heavy-duty, submerged arc-welded, thermally stress relieved, high strength steel base frame withstands the constant pressures of crushing

Simple and convenient hand pump to quickly change crusher setting

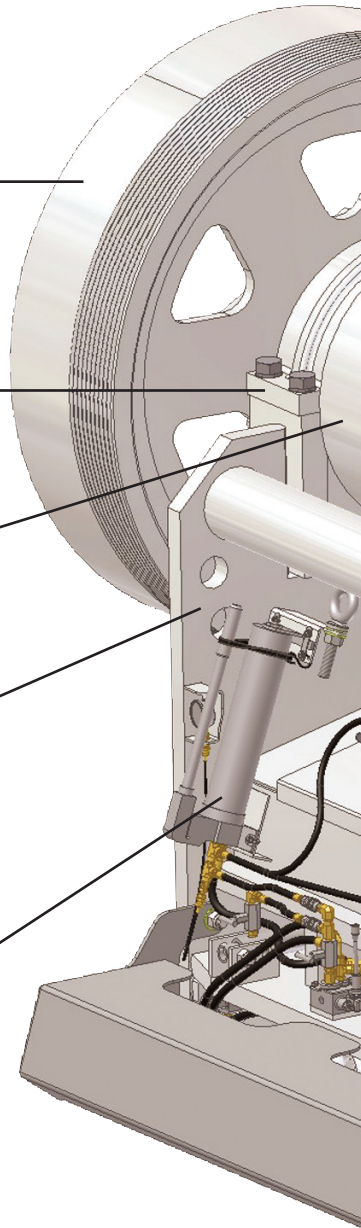

TEREX®

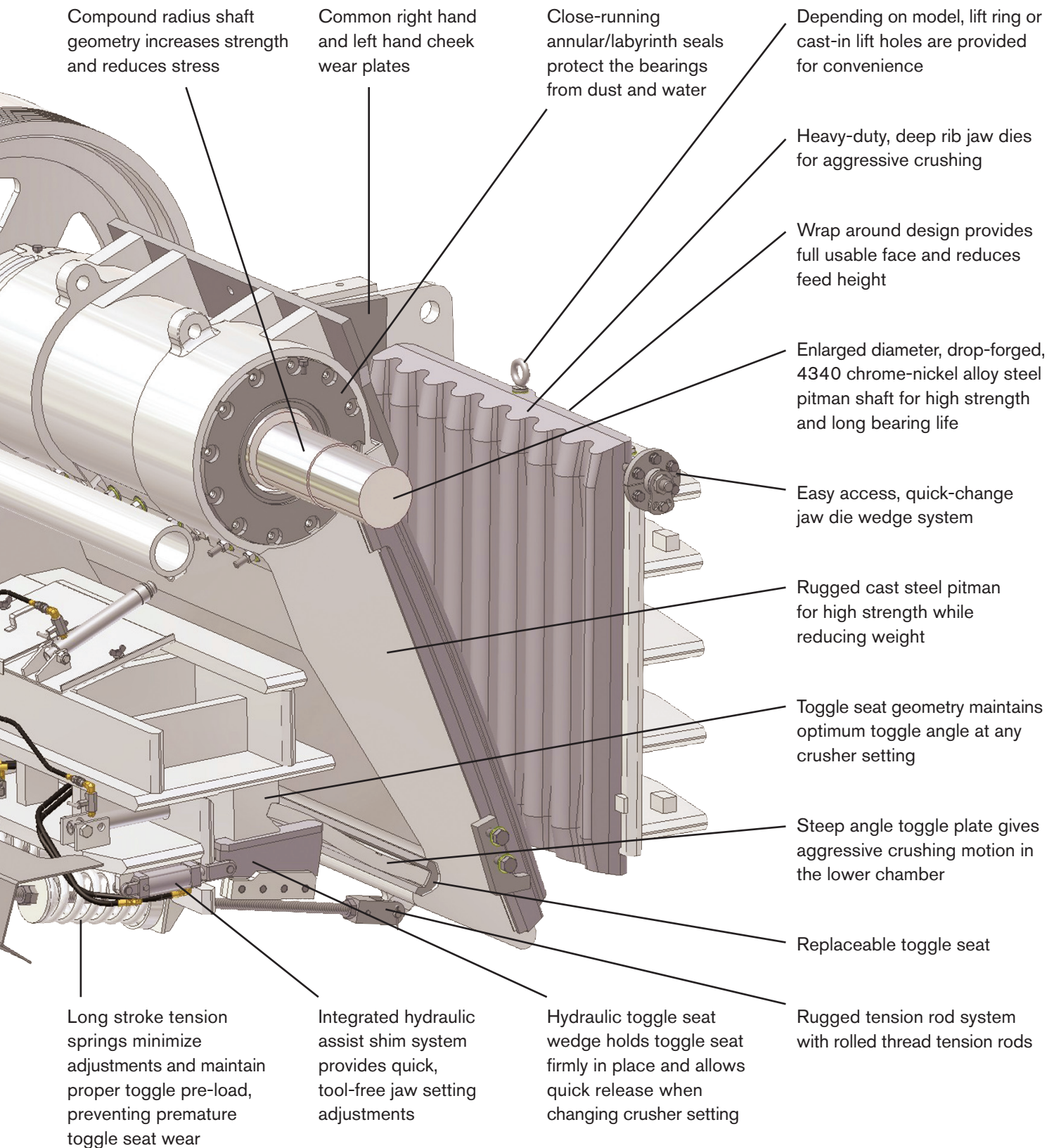



Terex® Minerals Processing Systems

North America

+1 (800) 248-3821

Latin/South America

+1 (989) 288-3121

Europe, Africa, Middle East

+44 (0) 28 82 418 790

Australia

+61 3 8551 9300

Hosur, India

+91 4344 302000

Delhi, India

+91 11 4361 0000

Kuala Lumpur, Malaysia

+60 3 5631 6199

Bangkok, Thailand

+66 38 214761

Give us a call to learn more about our extensive equipment range.

www.terexmps.com

Effective Date: March 2011. Product specifications and prices are subject to change without notice or obligation. The photographs and/or drawings in this document are for illustrative purposes only. Refer to the appropriate Operator's Manual for instructions on the proper use of this equipment. Failure to follow the appropriate Operator's Manual when using our equipment or to otherwise act irresponsibly may result in serious injury or death. The only warranty applicable to our equipment is the standard written warranty applicable to the particular product and sale and Terex makes no other warranty, express or implied. Products and services listed may be trademarks, service marks or trade-names of Terex Corporation and/or its subsidiaries in the USA and other countries. All rights are reserved. Terex is a registered trademark of Terex Corporation in the USA and many other countries. © 2011 Terex Corporation.

Terex® Minerals Processing Systems
Form 24214 (3/11)



TEREX®

WORKS FOR YOU.™

JS SERIES JAW CRUSHERS



Features and Benefits

- ▶ High strength jaw base; structural grade steel used in base frame for rugged crushing; deep rib depth maintains base stiffness
- ▶ Fast and easy stationary jaw die replacement; lift provisions provided in various jaw dies; no welding of a lifting loop required; jaw die wedges are easily accessible from the sides of crusher; no jaw die shimming required; lips removed from the sides of jaw die; jaw die can be replaced without removing cheek plates
- ▶ Tool-free closed side setting adjustment; hydraulically tightened and loosened toggle seat wedges
- ▶ Hydraulic hand pump conveniently located on crusher to quickly change crusher setting without tools
- ▶ Simple cheek plate replacement; no wedging for easy maintenance
- ▶ Reduced pitman toe wear; better alignment of jaw dies at small closed side settings; replaceable toe plate (JS3750 & JS4552)
- ▶ Drop-forged, heat-treated 4340 steel shaft with compound radii geometry handles tough crushing applications
- ▶ Simple, low-maintenance hydraulic assisted shim adjust is built rugged for long, reliable crushing in demanding applications
- ▶ Hydraulic toggle option; button operated for fast and easy closed side setting adjustments; provides overload protection by allowing uncrushables to pass through

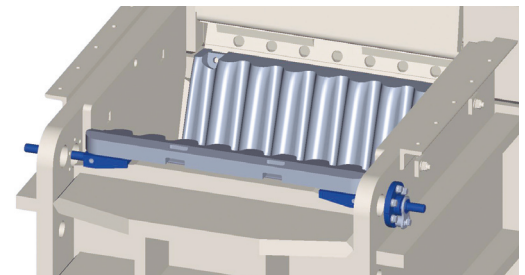

Quick-Change Jaw Die System

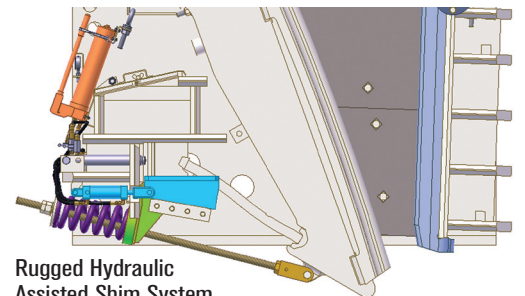

Rugged Hydraulic Assisted Shim System

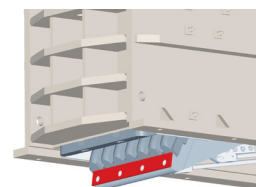

Replaceable Toe Plate

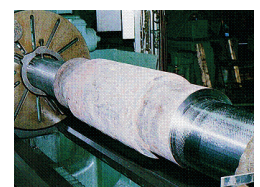

High Strength Shaft

www.terexmps.com

Effective Date: February 2012. Product specifications and prices are subject to change without notice or obligation. The photographs and/or drawings in this document are for illustrative purposes only. Refer to the appropriate Operator's Manual for instructions on the proper use of this equipment. Failure to follow the appropriate Operator's Manual when using our equipment or to otherwise act irresponsibly may result in serious injury or death. The only warranty applicable to our equipment is the standard written warranty applicable to the particular product and sale and Terex makes no other warranty, express or implied. Products and services listed may be trademarks, service marks or trade-names of Terex Corporation and/or its subsidiaries in the USA and other countries. All rights are reserved. Terex is a registered trademark of Terex Corporation in the USA and many other countries. © 2012 Terex Corporation.

JS SERIES JAW CRUSHERS



STANDARD FEATURES

- ▶ Easy removal jaw die wedge system
- ▶ Quick adjust jaw settings
 - Integrated hydraulic assist shim system
 - Hydraulic release toggle seat
- ▶ High strength eccentric shaft
 - Enlarged diameter with compound geometry
 - Drop-forged heat-treated 4340 chrome-nickel-steel
- ▶ Aggressive toggle angle
- ▶ Large spherical self-aligning roller bearings
- ▶ Removable bearing housings
- ▶ High strength submerged arc welded stress relieved base frame
- ▶ Rugged cast steel pitman with grease lubrication
- ▶ Replaceable toe protector (JS3750 and JS4552)
- ▶ Long life rugged tension rod system
- ▶ Machined face jaw die support faces
- ▶ Heavy-duty deep rib jaw dies
- ▶ Full height wrap around stationary die
- ▶ Lift provisions cast in various jaw dies
- ▶ Large diameter split hub flywheels

OPTIONAL EQUIPMENT

- ▶ Hydraulic toggle for hydraulic adjustment and overload relief
- ▶ V-belt drives
- ▶ Sloped feed plate with bolt-on replaceable AR400 liner

SPECIFICATIONS

Terex® Minerals Processing Systems Cedarapids JS Series Jaw Crushers

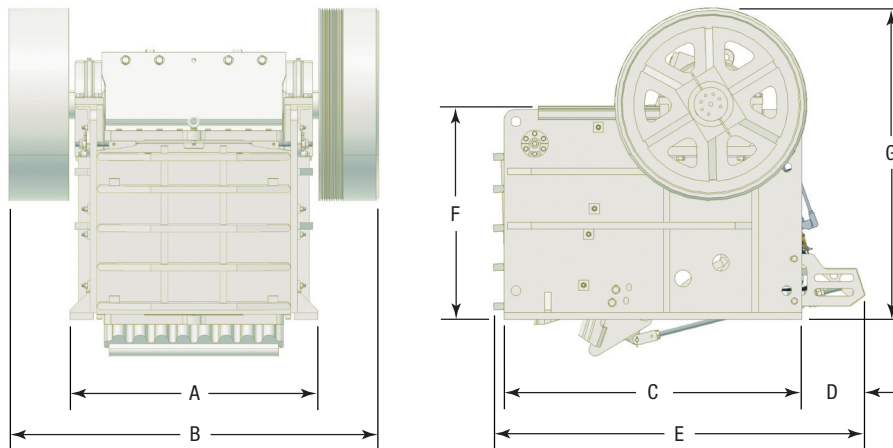

DIMENSIONS

Model	A	B	C	D	E	F	G
JS3042	62.5" (1588 mm)	99" (2515 mm)	88" (2235 mm)	19" (483 mm)	110" (2794 mm)	63" (1600 mm)	92" (2337 mm)
JS3054	73.5" (1867 mm)	110" (2794 mm)	88" (2235 mm)	19" (483 mm)	110" (2794 mm)	63" (1600 mm)	92" (2337 mm)
JS3750	70.5" (1791 mm)	103" (2616 mm)	107" (2717 mm)	22.5" (571 mm)	135.5" (3441 mm)	82.5" (2096 mm)	113.5" (2883 mm)
JS4552	75.5" (1918 mm)	109" (2769 mm)	121" (3073 mm)	14" (356 mm)	139.5" (3543 mm)	93.5" (2375 mm)	133" (3378 mm)

SPECIFICATIONS

Model	Weights	HP	RPM	Jaw Opening	Flywheel Diameter	Flywheel Face	Stationary Jaw Length	Movable Jaw Length
JS3042	43,800 lb (19,868 kg)	125-175 (93-130 kW)	225-275	30" x 43" (762 x 1092 mm)	57" (1448 mm)	18" (457 mm)	57" (1448 mm)	65" (1651 mm)
JS3054	51,800 lb (23,497 kg)	150-200 (112-149 kW)	225-275	30" x 54" (762 x 1372 mm)	57" (1448 mm)	18" (457 mm)	57" (1448 mm)	65" (1651 mm)
JS3750	80,000 lb (36,288 kg)	200-250 (149-186 kW)	200-250	37" x 50" (940 x 1270 mm)	60" (1524 mm)	13" (330 mm)	77" (1955 mm)	85" (2159 mm)
JS4552	104,600 lb (47,446 kg)	250-300 (186-224 kW)	200-275	45" x 52" (1143 x 1321 mm)	73" (1854 mm)	13" (330 mm)	90" (2286 mm)	98" (2489 mm)

PEAK TO PEAK CLOSED SIDE SETTING

Model	Minimum (closed)	Measured* (open)	Maximum (closed)	Measured* (open)
JS3042	3" (76 mm)	4.5" (114 mm)	10.5" (267 mm)	12" (305 mm)
JS3054	3" (76 mm)	4.5" (114 mm)	10.5" (267 mm)	12" (305 mm)
JS3750	4" (102 mm)	5.5" (140 mm)	13" (330 mm)	14.5" (368 mm)
JS4552	4.5" (114 mm)	6" (152 mm)	13" (330 mm)	14.5" (368 mm)

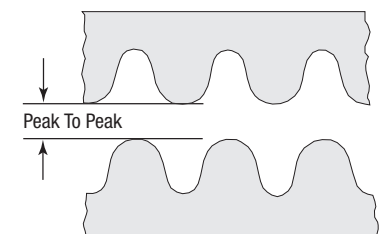

*Measure at rest (open) position. Dimensions and specifications to nearest inch and mm.

www.terexmps.com

Effective Date: March 2012. Product specifications and prices are subject to change without notice or obligation. The photographs and/or drawings in this document are for illustrative purposes only. Refer to the appropriate Operator's Manual for instructions on the proper use of this equipment. Failure to follow the appropriate Operator's Manual when using our equipment or to otherwise act irresponsibly may result in serious injury or death. The only warranty applicable to our equipment is the standard written warranty applicable to the particular product and sale and Terex makes no other warranty, express or implied. Products and services listed may be trademarks, service marks or trade-names of Terex Corporation and/or its subsidiaries in the USA and other countries. All rights are reserved. Terex is a registered trademark of Terex Corporation in the USA and many other countries. © 2012 Terex Corporation.

Terex® Minerals Processing Systems, 909 17th Street NE, Cedar Rapids, IA 52402 USA
Tel +1 319 363 3511 Fax +1 319 399 4871 www.terexmps.com

Form 24213 (3/12)



WORKS FOR YOU.™

Jaw Crushers

Cedarapids Series

Performance Meets Productivity

The Terex® Cedarapids line of jaw crushers comes with a proven track record of outstanding performance and productivity.

They're easy to use and built to last, designed to help you maximize profitability day in and day out.

Setting New Standards

With features like pitman drop-forged, 4340 chrome-moly-nickel steel shaft and spherical self aligning roller bearings, the advanced engineering behind the range is setting new standards for industry.

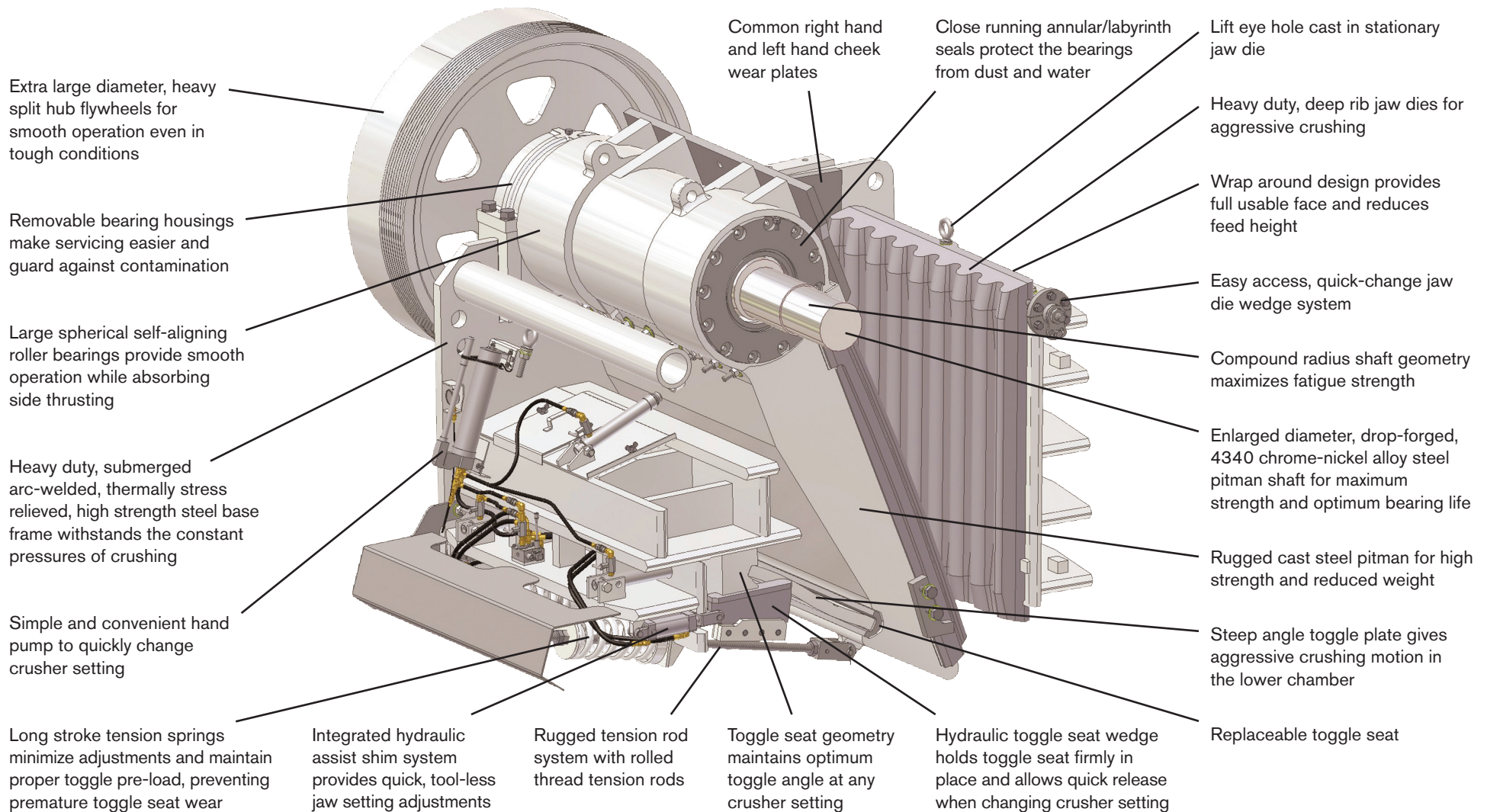

Model	Motor Size	Feed Opening (mm)	Basic Crusher Weight	Setting Range (mm)	Capacity (MTPH)	Standard Adjustment	Frame Style	Lubrication System
JC2236	100 hp (75 kW)	22 x 36" (559 x 914)	24,900 lbs (11,300 Kg)	2.5 - 6" (65 - 150)	60 - 265 (55 - 240)	Shim	Welded	Grease or Oil
JS3042	150 hp (110 kW)	30 x 43" (762 x 1092)	43,800 lbs (19,840 Kg)	4 - 12" (100 - 300)	130 - 800 (120 - 730)	Hydraulic/ Shim	Welded	Grease
JS3054	200 hp (150 kW)	30 x 54" (762 x 1372)	51,800 lbs (23,470 Kg)	4 - 12" (100 - 300)	215 - 1500 (195 - 1360)	Hydraulic/ Shim	Welded	Grease
JS3750	250 hp (185 kW)	37 x 50" (940 x 1270)	80,000 lbs (36,290 Kg)	4 - 12" (100 - 300)	200 - 1300 (180 - 1180)	Hydraulic/ Shim	Welded	Grease
JS4552	300 hp (225 kW)	45 x 52" (1143 x 1321)	104,600 lbs (47,450 Kg)	4 - 12" (100 - 300)	200 - 1300 (180 - 1180)	Hydraulic/ Shim	Welded	Grease
JC3660	250 hp (185 kW)	36 x 60" (914 x 1524)	107,670 lbs (48,840 Kg)	4 - 12" (100 - 300)	250 - 1700 (225 - 1540)	Shim	Welded	Grease or Oil
JC5460	400 hp (300 kW)	54 x 60" (1372 x 1524)	196,260 lbs (89,030 Kg)	6 - 12" (150 - 300)	425 - 1700 (385 - 1540)	Shim	Welded	Oil

Terex® Cedarapids JS Series Jaw Crushers

Effective Date: October 2010. Product specifications and prices are subject to change without notice or obligation. The photographs and/or drawings in this document are for illustrative purposes only. Refer to the appropriate Operator's Manual for instructions on the proper use of this equipment. Failure to follow the appropriate Operator's Manual when using our equipment or to otherwise act irresponsibly may result in serious injury or death. The only warranty applicable to our equipment is the standard written warranty applicable to the particular product and sale and Terex makes no other warranty, express or implied. Products and services listed may be trademarks, service marks or trade-names of Terex Corporation and/or its subsidiaries in the USA and other countries. All rights are reserved. Terex is a registered trademark of Terex Corporation in the USA and many other countries. © 2010 Terex Corporation.